

AKS
ESTATES



London Road Feltham

£454,950

Freehold

PLANNING APPROVED

<https://publicaccess.spelthorne.gov.uk/online-applications/applicationDetails.do?keyVal=RQKZX6PBG7000&activeTab=summary>

This three bedroom end of terrace house offers a delightful blend of comfort and potential. The ground floor features two reception rooms, two shower rooms and an extended kitchen dining area is a standout feature, offering ample room for dining and cooking. Upstairs, you will find three bedrooms, providing plenty of space for family or guests.

Outside, the house benefits from a garage at the rear, providing secure storage or parking options, along with off street parking for added convenience. The garden space offers a lovely area for outdoor activities or simply enjoying the fresh air.

Additionally, planning permission has been approved for further improvements, allowing the new owner to enhance the property to their liking and potentially increase its value. This home is ideally situated, with easy access to local amenities, schools, and transport links, making it a perfect choice for families or professionals alike.



London Road, Feltham

Approximate Gross Internal Area
883 sq ft - 82 sq m

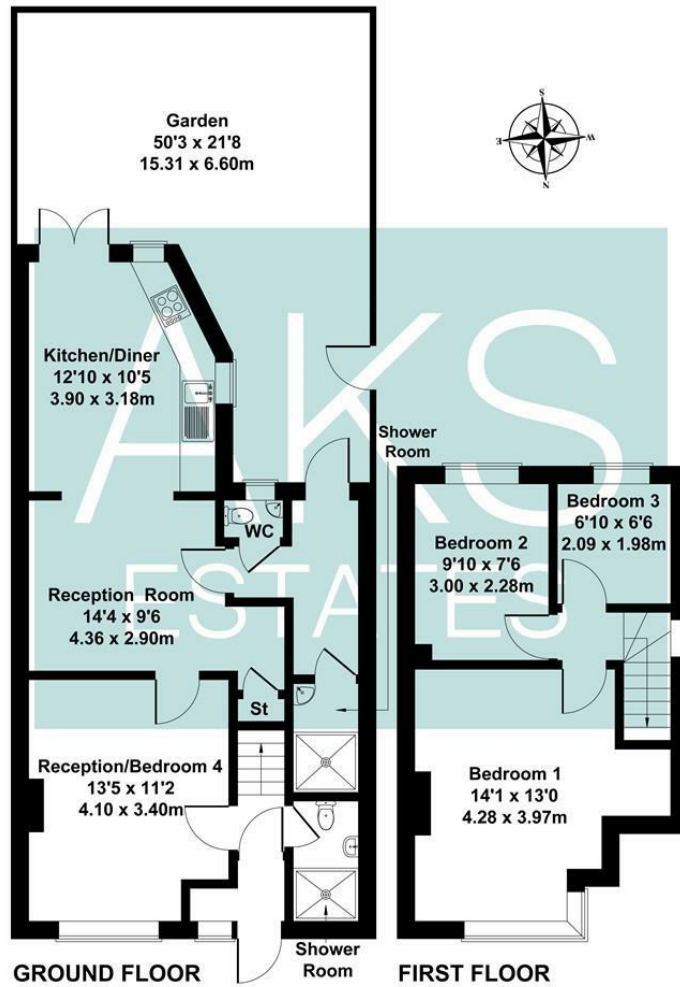

Not to Scale. Produced by The Plan Portal 2025
For Illustrative Purposes Only.



Energy Efficiency Rating		
	Current	Potential
Very energy efficient - lower running costs		
(92 plus) A		83
(81-91) B		
(69-80) C		
(55-68) D	65	
(39-54) E		
(21-38) F		
(1-20) G		
Not energy efficient - higher running costs		
England & Wales		EU Directive 2002/91/EC

Agents Note: Whilst every care has been taken to prepare these particulars, they are for guidance purposes only. All measurements are approximate and are for general guidance purposes only and whilst every care has been taken to ensure their accuracy, they should not be relied upon and potential buyers/tenants are advised to recheck the measurements

Heston
131A Heston Road
Hounslow
TW5 0RF

020 8059 0595
shiv@aksestates.co.uk
aksestates.co.uk

